

DRAWING NO. XRL-G03

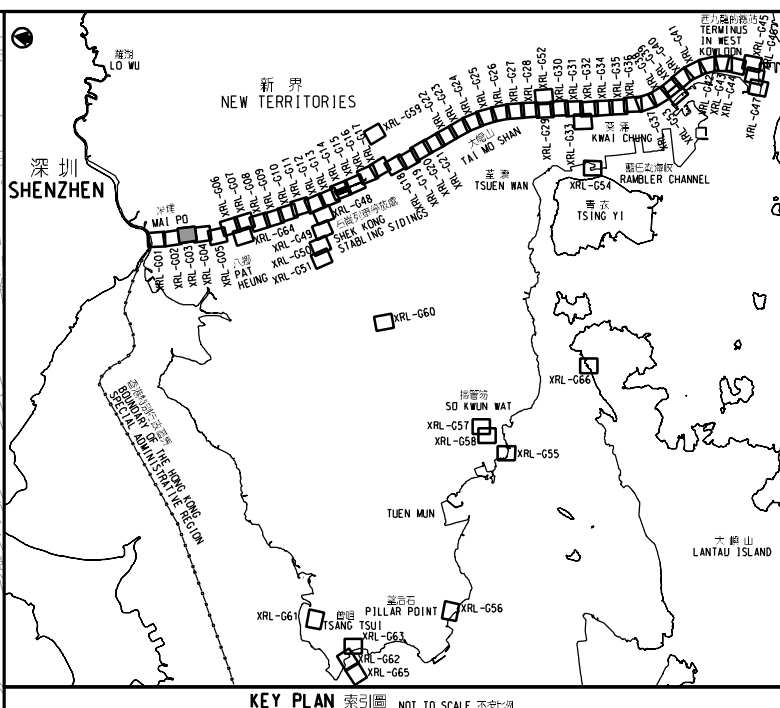

**圖例 LEGEND**

- 方案界線 BOUNDARY OF THE SCHEME
- 擬建的車站及其他鐵路設施 PROPOSED STATION AND OTHER RAILWAY FACILITIES
- 擬建的車站及其他鐵路設施(地下) PROPOSED STATION AND OTHER RAILWAY FACILITIES (UNDERGROUND)
- 擬建的鑽挖或掘或鑽爆隧道 PROPOSED BORED / MINED / DRILL AND BLAST TUNNEL
- 擬採用明挖回填法興建的鐵路設施或隧道 PROPOSED RAILWAY FACILITIES/TUNNEL BY CUT-AND-COVER METHOD
- 擬建的地下臨時建築通道 PROPOSED TEMPORARY UNDERGROUND CONSTRUCTION ACCESS
- 可能永久封閉的道路(包括行車道和行人徑) WHICH MAY BE CLOSED PERMANENTLY
- 擬建的緊急車輛通道及行車道 PROPOSED EMERGENCY VEHICULAR ACCESS AND CARRIAGEWAY
- 擬建的行人徑 PROPOSED FOOTPATH
- 現有行人天橋將受影響 EXISTING FOOTBRIDGE TO BE AFFECTED
- 擬建的臨時行人天橋/地面行人過路處 PROPOSED TEMPORARY FOOTBRIDGE / AT-GRADE PEDESTRIAN CROSSING
- 擬建的行人天橋 PROPOSED FOOTBRIDGE
- 可能在其上進行填海工程或其他工程的政府前濱或海床 OVER OR UPON WHICH RECLAMATION OR OTHER WORKS MAY BE CARRIED OUT
- 圖則修改 DRAWING REVISION
- A1 修訂參考編號(參考憲報公告) AMENDMENT REFERENCE NUMBER (SEE GAZETTE NOTICE)
- 修訂範圍 AMENDMENT AREA

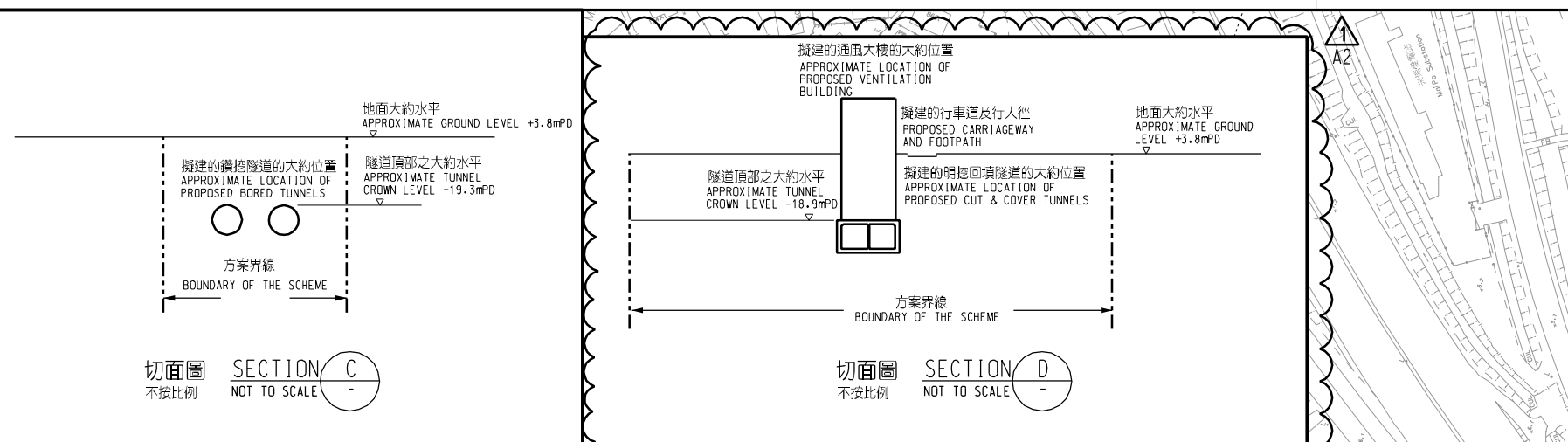
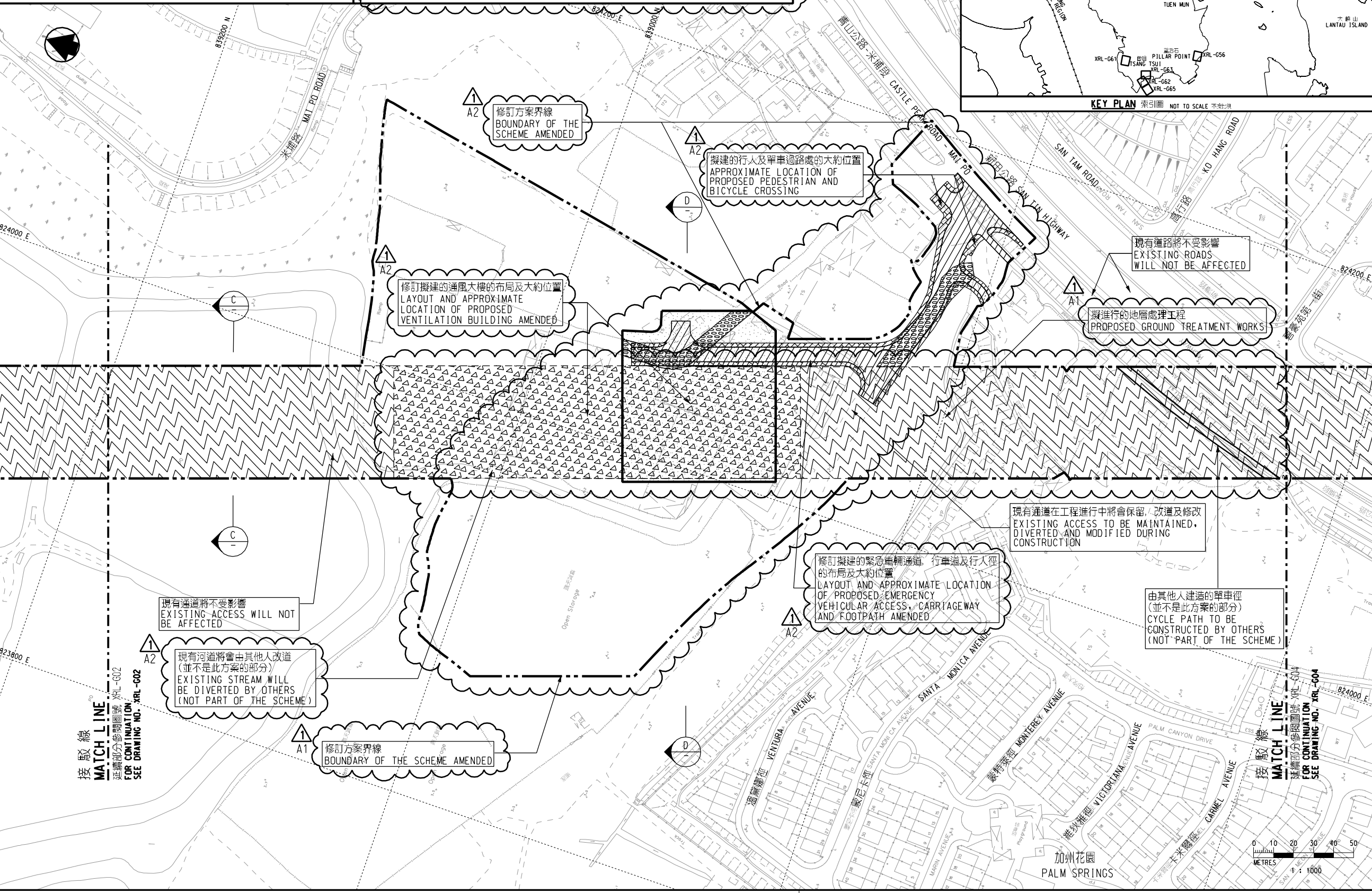

**一般說明 GENERAL NOTES**

1. 有關一般說明參閱圖號 XRL-G01.  
FOR GENERAL NOTES, REFER TO DRAWING NO. XRL-G01.

修訂表 TABLE OF AMENDMENTS

修訂日期 REV	修訂日期 DATE	修訂人 BY	修訂內容 SUB	修訂內容 DESCRIPTION	
17	17 APR 2005	CAO	DDW	PP	修訂項目 A1 及 A2 AMENDMENT ITEMS A1 AND A2 修訂圖則方格內內容及索引圖 TITLE BOX AND KEY PLAN AMENDED

獲准發出 APPROVED FOR ISSUE

路政署  
鐵路發展處處長(2)  
GOVERNMENT ENGINEER/  
RAILWAY DEVELOPMENT (2)  
HIGHWAYS DEPARTMENT

發出日期 DATE OF ISSUE

圖則名稱 DRAWING TITLE  
廣深港高速鐵路香港段  
鐵路條例(第519章)  
總體規劃圖則 66頁的第3頁  
HONG KONG SECTION OF  
GUANGZHOU - SHENZHEN - HONG KONG  
EXPRESS RAIL LINK  
RAILWAYS ORDINANCE (CHAPTER 519)  
GENERAL LAYOUT PLAN SHEET 3 OF 66

圖號 DRAWING NO. XRL - G03

比例 SCALE 1:1000 (A1)  
或如顯示  
AS SHOWN

香港特別行政區政府  
THE GOVERNMENT OF THE HONG KONG  
SPECIAL ADMINISTRATIVE REGION

路政署  
HIGHWAYS DEPARTMENT

鐵路拓展處  
RAILWAY DEVELOPMENT OFFICE

